



Northfields



GREENVIEW CLOSE
W3

£459,999

Acton

GREENVIEW CLOSE, W3

£459,999 Asking Price

Set on the first floor, this spacious apartment offers two bedrooms, two bathrooms; one ensuite and a spacious reception room which leads out to a south-facing balcony. The property further benefits from secure allocated parking.

Situated opposite Acton Park this delightful residence is just moments from a variety of convenient transport links and shopping options.

- First floor apartment
- Two bedrooms
- Two bathrooms; one ensuite
- Spacious reception room
- South facing balcony
- Secure allocated parking

At a glance



Two Bedrooms



Two Bathrooms



Acton Central



Tesco express



East Acton Primary School



Acton Park







APPROXIMATE GROSS INTERNAL AREA

GREENVIEW CLOSE

Approximate Gross Internal Area 710 sq ft / 66.0 sq m

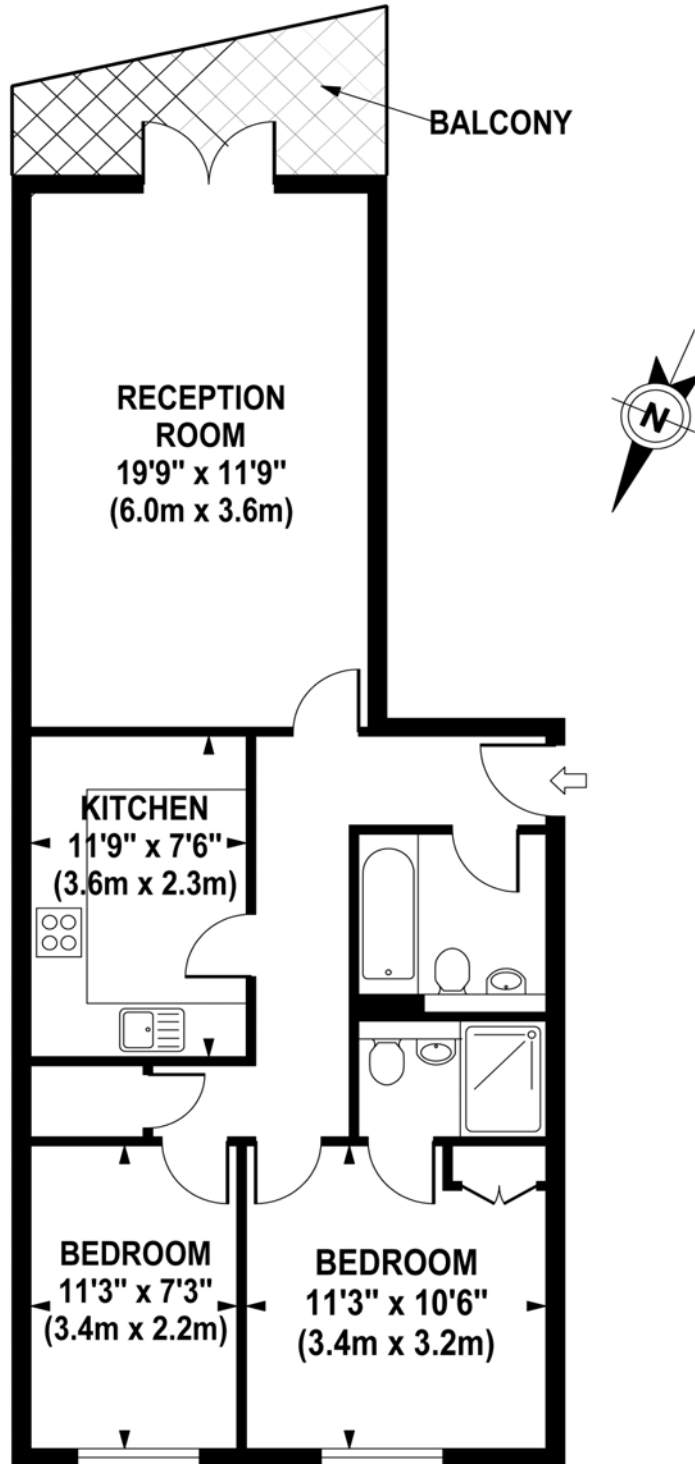

**FIRST FLOOR
GROSS INTERNAL
FLOOR AREA 710 SQ FT**

Although every attempt has been made to ensure accuracy, all measurements are approximate. The floor plan's for illustrative purposes only and not to scale. Measured in accordance to RICS standards.

LOCATION

Home to the Shepherd's Bush Empire, The Bush Theatre and the BBC, Shepherd's Bush is a vibrant cultural centre with a huge range of places to eat, drink and shop. Shepherd's Bush Green, Brook Green, Wendell Park and Ravenscourt Park all offer green spaces to relax while Westfield Shopping Centre is a prime destination for shopping. Schools popular with local families include Wendell Park and Greenside Primary Schools.



GENERAL

POSTCODE: W3
 LOCAL AUTHORITY: Ealing
 COUNCIL TAX BAND: D
 LEASE LENGTH: 108

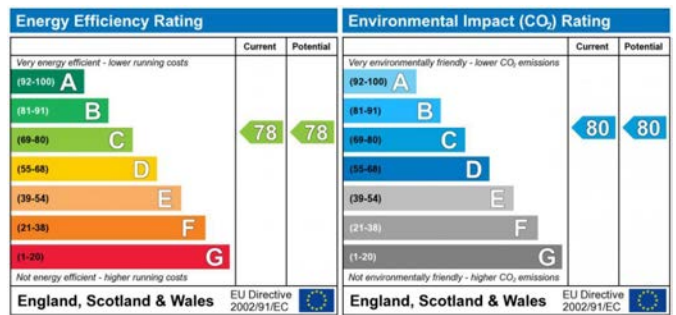

The energy efficiency rating is a measure of the overall efficiency of a home. The higher the rating the more energy efficient the home is and the lower the fuel bills will be.

The environmental impact rating is a measure of a home's impact on the environment in terms of carbon dioxide (CO₂) emissions. The higher the rating the less impact it has on the environment.

PROPERTY LOCATION



Your local independent
award winning estate agents



Tell us what you'd like to do with
your property in 2017 and we'll tailor
a plan for you to make it happen.

Shepherds Bush

127 Askew Road,
Shepherds Bush W12 9AU
Lettings: 020 8740 8833
E: enquiries@northfields.co.uk

020 8740 8833

www.northfields.co.uk

CONTACT

Us today

TO FIND OUT

MORE